

Technical data sheet



Product features

Bain marie electric GN 1/1 - 200 counter top

Model	SAP Code	00000056
--------------	-----------------	----------



- Drain: No
- Material: Stainless steel
- Protection of controls: IPX4
- Maximum device temperature [°C]: 90

SAP Code	00000056	Power electric [kW]	1.500
Net Width [mm]	395	Loading	230 V / 1N - 50 Hz
Net Depth [mm]	624	Number of GN / EN	1
Net Height [mm]	299	GN / EN size in device	GN 1/1
Net Weight [kg]	12.78	GN device depth	200

Technical data sheet

Technical drawing



Bain marie electric GN 1/1 - 200 counter top

Model

SAP Code

00000056

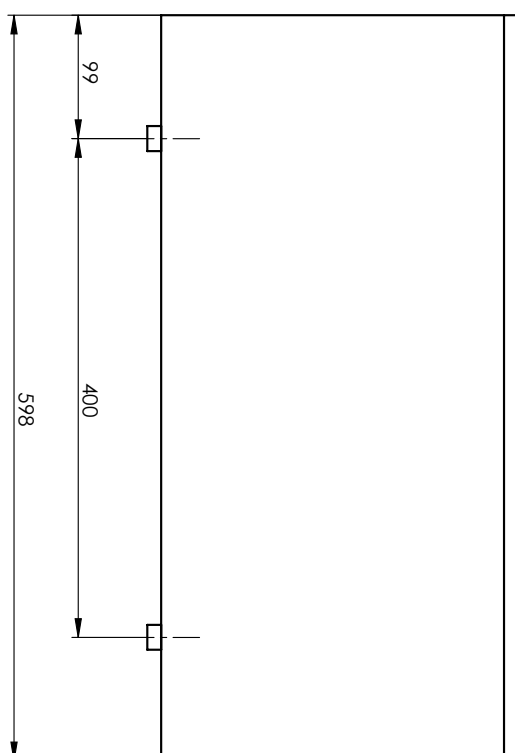
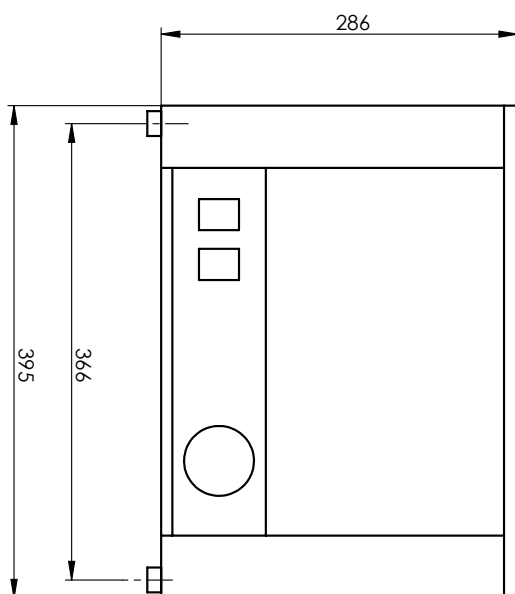

BM-1120

Technical data sheet



Product benefits

Bain marie electric GN 1/1 - 200 counter top

Model

SAP Code

00000056

1

All-stainless design

long life
resistance of AISI 304 stainless steel material
the material does not cut

- savings on service interventions
- easier and faster operation

2

Degree of protection of the control elements IPX4

maintenance-free system
resistance to splash water
long life

- savings on service interventions
- easy cleaning and maintenance of equipment

3

Easy manipulation

easy portability
- flexibility in the kitchen, can be used for banquets

Technical data sheet



Technical parameters

Bain marie electric GN 1/1 - 200 counter top

Model

SAP Code

00000056

1. SAP Code:

00000056

2. Net Width [mm]:

395

3. Net Depth [mm]:

624

4. Net Height [mm]:

299

5. Net Weight [kg]:

12.78

6. Gross Width [mm]:

330

7. Gross depth [mm]:

700

8. Gross Height [mm]:

440

9. Gross Weight [kg]:

14.28

10. Device type:

Electric unit

11. Construction type of device:

Table top

12. Power electric [kW]:

1.500

13. Loading:

230 V / 1N - 50 Hz

14. Protection of controls:

IPX4

15. Material:

Stainless steel

16. Indicators:

operation and warm-up

17. Maximum device temperature [°C]:

90

18. Minimum device temperature [°C]:

30

19. Drain:

No

20. Number of GN / EN:

1

21. GN / EN size in device:

GN 1/1

22. GN device depth:

200

23. Heating location:

Under the bottom of the bathtub

24. Cross-section of conductors CU [mm²]:

0,5

- Výkon (kW): 2,4-3,3 (230 V)